

REVISION HISTORY			
REV	DESCRIPTION	DATE	APPROVED
0	FIRST RELEASE	11/21/07	

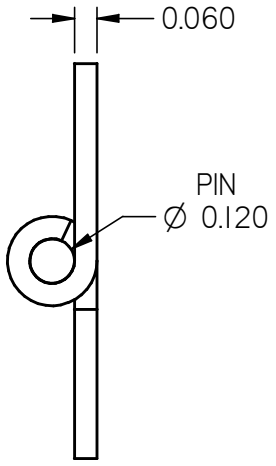
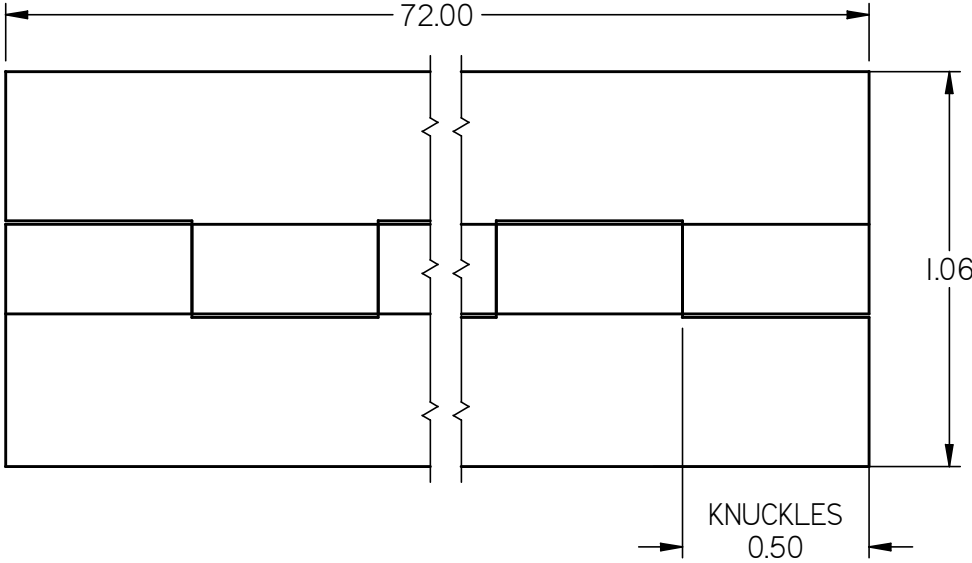

NOTES:

- 1. MATERIAL: ALUMINUM 5052 ALLOY
- 2. FINISH: NONE
- 3. SCALE: 3:1 (DO NOT SCALE)

	NAME		DATE
	DRAWN	TOM	11/21/07
<small>CE DOCUMENT AINSI QUE SON CONTENU SONT LA PROPRIETE DE QUICALLERIE INDUSTRIELLE NORMONT L.TEE. CE DOCUMENT CONTIENT DE L'INFORMATION CONFIDENTIELLE PROTEGEE EN DROIT. TOUTE REPRODUCTION, DISTRIBUTION, UTILISATION OU COMMUNICATION DE CE DOCUMENT OU DE SON CONTENU SANS CONSENTEMENT EXPRESS SONT STRICTEMENT INTERDITES.</small> <small>THIS DOCUMENT AND ITS CONTENTS ARE THE PROPERTY OF NORMONT INDUSTRIAL HARDWARE LTD. THIS DOCUMENT CONTAINS CONFIDENTIAL PROPRIETARY INFORMATION. THE REPRODUCTION, DISTRIBUTION, UTILISATION OR THE COMMUNICATION OF THIS DOCUMENT OR ANY PART THEREOF, WITHOUT EXPRESS AUTHORISATION IS STRICTLY FORBIDDEN.</small>	DWG NO		REV
	AL061632		0
	TITLE		
CONTINUOUS HINGE			
REMOVE ALL BURRS & BREAK ALL SHARP EDGES ALL DIMENSIONS ARE IN INCHES UNLESS OTHERWISE SPECIFIED	TOLERANCES		THIRD ANGLE PROJECTION
	XX	±0.060	
	XXX	±0.030	
	XXXX	±0.015	SCALE
	ANGLES	±1.0°	N.T.S.
HOLES	±0.005	SIZE	
SHEET 1 OF 1			B